

PRICING



SHIFT

4 Hours

6 Hours

8 Hours

10 Hours

12 Hours

RATE

Rs 6000/-

Rs 9000/-

Rs 12000/-

Rs 14000/-

Rs 16000/-

- 50% Advance is necessary for booking confirmation.
- Payment needs to be released on the same day.
- 18% Gst will be applicable.

- Electricity charges included.
- One studio assistant will be present.
- ₹2000/- Extra per hour over 4/6/8/10/12 hours.
- Minimum 2 hours booking is available.
- ₹ 500/- extra for bookings on Sunday & Public Holidays.

FLOOR PLAN

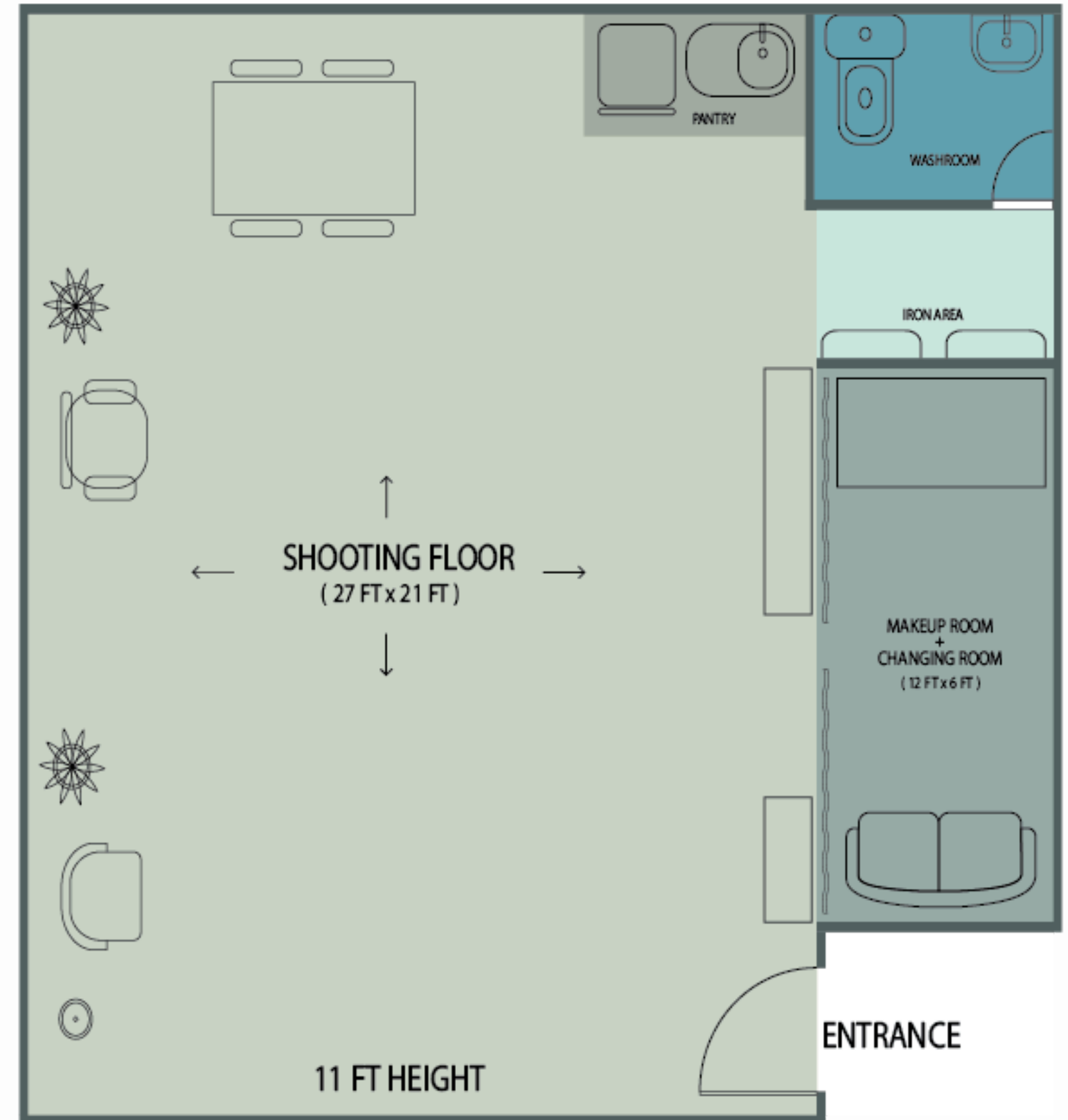

PAPER BACKDROPS





SET ONE

SET TWO



SET THREE





SET FOUR



MAKEUP / CHANGING ROOM

PANTRY



WASHROOM



EQUIPMENTS

VIDEO LIGHTS

- Godox led light sl 150w ---> qty 02.
- Digitek led light 150w ---> qty 02.
- Godox litemons 150bi color ---> qty 02.

MODIFIERS

- Beauty dish 44cm with grid ---> qty 01.
- Rotalux 1x1 soft box Elinchrom ---> qty 02.
- Rotalux 130x50 strip box Elinchrom ---> qty 02.
- Rotalux deep octa 100cm elinchrom ---> qty 01.
- Rotalux octa 135cm elinchrom ---> qty 01.
- Godox qrp 120 deep parabolic softbox with grid ---> qty 01.
- Grids, cutter flags, sand bags, super clamps.
- 5 in 1 reflector.

PHOTO LIGHTS

- Elinchrom frx 400 ---> qty 02.
- Elinchrom frx 200 ---> qty 02.

STANDS

- Heavy duty boom stands ---> qty 02.
- 12 feet stands ---> qty 05.
- 9 feet stands ---> qty 10.
- Base stands ---> qty 02.

STUDIO POLICY

- The client's booking time will mark the start of the studio rental period, as opposed to the beginning of the shoot itself.
- Please note that if the studio has been reserved by another client after your designated time slot, it is important that you vacate the studio promptly at the end of your booking time.
- We allow a grace period of 30 minutes for pack up. However, if the pack-up time exceeds 30 minutes, an additional hourly charge will apply.
- Please be aware that during the booking session, the client is fully responsible for any damages that occur, regardless of who caused them. any damages will be charged to the client.
- To maintain the cleanliness and safety of the studio, the use of paint, flour, or any other form of powder is strictly prohibited.
- Please note that nailing, painting, or any form of sticking on the walls of the studio is strictly prohibited.
- The crew size capacity in the studio is between 10 to 15 people, including artists. • please note that cooking inside or outside the studio is strictly prohibited by the society. however, catering services are allowed.
- We kindly request that the studio be used with utmost care and cleanliness is maintained at all times.
- No smoking inside the studio.

CONTACT

- 9321391484
- www.thebombaystudio.in
- Unit 04, 4th floor, parth business plaza, mith chowki, new link road, malad west, mumbai - 400064.
- Landmark- poptates, malad opposite 'valnai' metro station.